



FRIENDS OF ANSTEY HILL



ABN: 53 952 413 248

PO Box 653

ST. AGNES SA 5097

NEWSLETTER

JUNE 2024

NO: 03/2024

DIARY DATES

June 2024	Park of the Month	Anstey Hill Recreation Park
Sunday 23 rd June 2024	Planting Day	Meet at Shed – Gate 18
Sunday 30 th June 2024	Bird Spotting Walk by Birds SA	Meet at Shed – Gate 18
Wednesday 7 th August 2024	Committee Meeting	Houghton
Sunday 22 nd September 2024	Bushcare Session	TBA
Tuesday 1 st October 2024	Memberships Due	
Wednesday 16 th October 2024	Annual General Meeting	TBA
Sunday November 2024	Propagation Day	TBA

C.F. NEWMAN & SON – THE MODEL NURSERY

WATER GULLY 1854 - 1932 – PART 1



The Newman era at Water Gully commenced in 1854 when Charles Frederick Newman purchased 68 acres of 'open land' (i.e. unfenced), being Section No. 5547. He was reported to have spent a short time at the 'diggings' during the Victorian gold rush but without success, which was probably right because he obviously had to borrow money to make the purchase and a mortgage on the property was registered in July 1854 – £300 @ 12.5%. This mortgage was discharged in 1868 and a re-mortgage of the same property to the Savings Bank of South Australia for £400 @ 8% was registered. The first mortgage was registered as 'Charles Neuman', farmer of Tea Tree Gully.

As the name Water Gully indicates, the original area was well watered with a natural spring. There was some area of arable flats, but most of it would have been heavily timbered. The house of 1856 was not much more than a slab hut built into the bank of a hill.

It appears that from at least the 1850s he had been using the anglicised version of his name (Carl Friedrich Neumann). The story handed down in the family says that he claimed that as he was living and trading in an English country, he didn't want to be a German but wanted to be regarded as English.

From 1854 to the 1870s Water Gully was continuously being cleared and developed and planted, during some portion of which Charles Frederick was often away augmenting his income with his wagon and team carting goods to and from the River at Mannum.

About 1869 Section No. 5635, of 76 acres, was acquired from 'the Curator of Intestate Estates at Townsend & Co.' Subsequently Section 5632 (65 acres), Section 5548 (84 acres), Section 5608 (82 acres) and Section 5403 (94 acres) were added, spreading the Water Gully enterprise over a total of 469 acres. In the Land Tax Return submitted for the 1st January, 1885, the value of the land and improvements on these acres was shown as £7,850. Curiously, though, Charles Frederick gave his occupation as 'Market Gardener' when The Model Nursery must have been well and truly operational at that stage.

Section 5548 and 5608 were south of Anstey's Hill Road, and always referred to in Newman's time as 'John Payne's Gully'. The orangery was situated in this area.

The following description and detail is from "Years of Endeavour" by Robert F.G. Swinbourne, published 1982 by the S.A. Association of Nurserymen:

'The property developed into what was considered a "show-piece" of the colony in its day, and became the site of what eventually was to become known as "The Model Nursery", operated by C.F. Newman & Son. It would appear that "The Model Nursery", as such, dates from 1875, however sketches of Water Gully in 1870 show hothouses, etc. already well and truly established. This would suggest that the commencement of the property also saw the first 'development' of a nursery. In addition, the variety of plants and stock held could only have been developed over a number of years, and at the time of the "Model Nursery" appearing, the range carried was very extensive indeed. Catalogues issued by the Nursery were most comprehensive and numbered many pages, full of illustrations. Plants and seeds were imported from, and exported to, many countries throughout the world.'

Extracts from Water Gully, 1854 – 1932 CF Newman & Son, The Model Nursery compiled by:

Beth Brittle (grand-daughter of John Newman) from original research and with the help of additional information from Alwin Clements (grandson of Charlotte Newman – Mrs. Short) and Daphne Machin (daughter of Georgina Newman – Mrs. Palm).

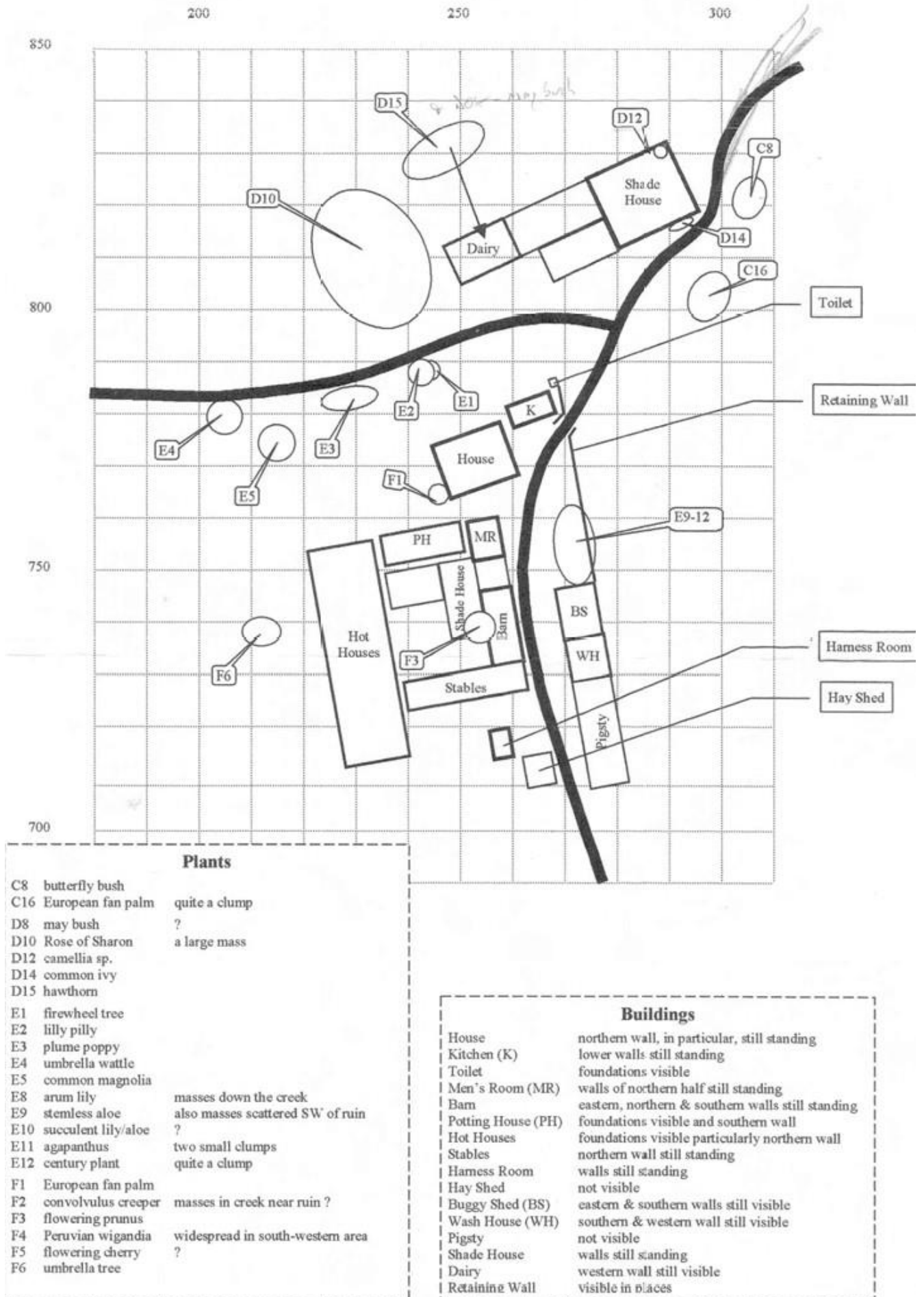

PRESIDENT'S REPORT

Each year Friends of Anstey Hill contribute over 1,200 hours of effort in the park, mostly through a Wednesday Bushcare Group but also through Propagation and Planting Days. Last year we trialled a Sunday Bushcare Session to cater for those members who could not come out during the week. Our first one was a great success with 16 members turning up, with 13 at our previous session in April. It is always great to see some of the younger members who can't make the regular Wednesday sessions. We will continue to plan to have at least 2 Sunday sessions per year.

National Parks and Wildlife Service has designated Anstey Hill Recreation Park as one of the Parks of the Month for June. We have 2 events planned for the month as part of that designation, namely the Planting Day on the 23rd of June and a Birds SA bird watching event for Sunday 30th June. Hopefully we can use this platform as a way of attracting some new members.

On the theme of attracting new members, we once again participated in the Tea Tree Gully Council Community Expo on Friday 7th June. This was a great opportunity to mix with like-minded volunteer groups and engage with the general public as they wandered through the expo. Many thanks to those who helped out with our stand.

Adopt a patch continues to be successful with 3 areas under adoption. We seem to have a reasonable system in place in terms of keeping track of the activities so it is probably time to see if we can expand the initiative by inviting other members to join in.

We received the following notice from Landcare SA,

We are very pleased to inform you that your request for a Care for Landcare Grant has been successful. The Care for Landcare grant amount for 2024 is \$1,893.94 (GST excl).

Good news! These funds can be used for tools and equipment to support our activities in the park. So far, we have identified a "dropper knocker" for installing star droppers, additional mattocks and secateurs, and a second reciprocating saw. We are still looking for additional items to add to the list.

The highlight of the year for me has always been Planting Day. We spend so much time in the park getting rid of pest plants that it is a nice contrast to actually plant something. The dry weather has meant that the date was postponed to Sunday 23rd June but this has given us some more time to prepare the site. And it is a challenging site, with the usual rocky ground as well as the site being a favourite for the kangaroos who enjoy nothing more than chewing on a tasty seedling. We have had to beef up the plant guards and I am confident they will protect the plants until they are big enough to no longer be attractive to the kangaroos.

Finally, I would once again like to thank the committee for supporting the Friends with your time and effort.

Steve Lukacs

5th June 2024

BUSHCARE REPORT

This is a summary of activities undertaken from 1st April 2024 to 31st May 2024:

- Continued the work along the Wednesday Loop targeting African daisy, olives, boneseed
- Bushcare Sunday attracted 13 members who tackled the boneseed and fencing removal on the Powerline Track / Range Road South Track
- Gate 1 quarry area boneseed, WA wattle, olive
- Planting Day preparations including digging holes and making tree guards
- Spraying bridal creeper around Wednesday Loop and Ridgetop
- "Adopt a Patch" continued with the current 3 areas

Future activities include:

- Gate 5, clearing any fresh growth of boneseed, check on olives
- Wednesday Loop – follow up last year's work and link hours to 2024 FOP Grant

- Return to Angove Conservation Park – bulbous weeds
- Newmans Track / Bursaria Loop – follow up on bluebell creeper
- Remove old fencing, particularly those which include barb wire strands.

Statistics for the Bushcare Group activities for this period:

- 10 Wednesday mornings sessions plus a Sunday session
- Total of 302.5 hours plus 69 hours from Adopt a Patch
- Average number of hours per activity is 30.25
- Average number of workers per morning session is 11

5th June 2024



Adopt a Patch

Over the years Friends of Anstey Hill have done a number of things to try and engage the membership who can't make it to the regular Wednesday Bushcare Sessions. This has included Planting and Propagation Day and more recently Bushcare Sundays. We value your membership regardless of how much time you can spend in the park, it is a vote of thanks and support for the things we do in the park. Having said that we are also keen to give people the opportunity to contribute in other ways to the efforts of restoring and preserving the park.

One new idea we are trialling at the moment is the concept of "Adopt a Patch". This essentially involves members, as individuals or family groups, "adopting" an area in the park and undertaking maintenance in that area at times that are convenient to them. They can do as little or as much as they can manage and adopt new areas if they want to explore a new site. The main initial activity would be invasive weed control and could lead to plantings in the area if that was deemed beneficial and in line with other plantings in the park. Note that this could also include Angove Scrub Conservation Park.

Please contact Steve Lukacs, President & Bushcare Co-ordinator via our email: Anstey.friends@gmail.com to discuss your involvement.

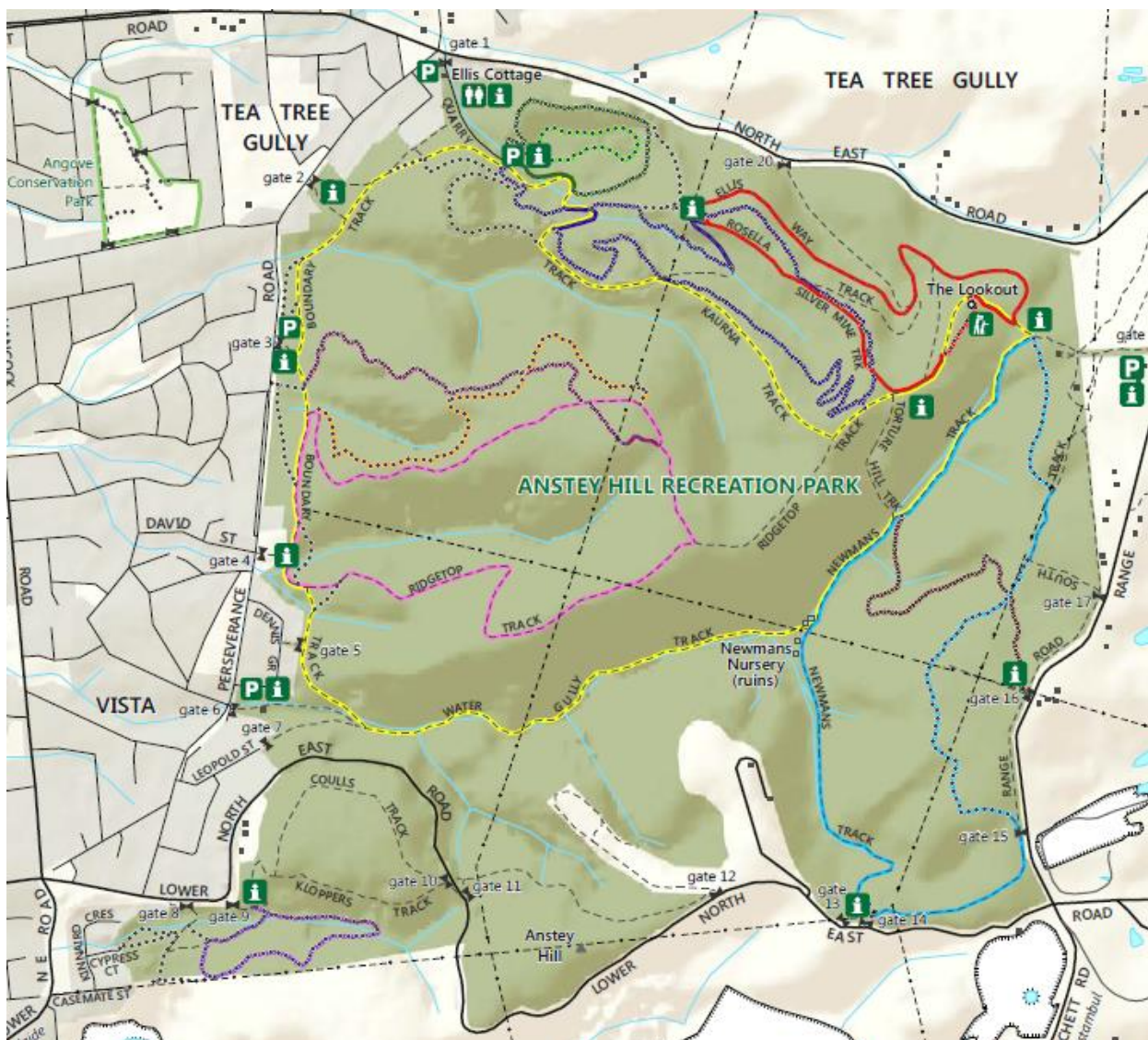

NEW MEMBERS

Welcome to our new members who have joined since our last newsletter.

Lauren O'Malley

Kim and Mark Fairney

Allan Plunkett

YOUR 2023-2024 COMMITTEE:

President:

Steve Lukacs

Secretary:

Diann Lozoraitis

Treasurer:

Kevin Laurance

Committee Members:

Marie Mudge

Roger Collier

Rob Carthew

Christine Thomas

Jenny Carthew

Roberta Swift

Jacqueline Scaffidi

Newsletter: Diann Lozoraitis

Facebook: Christine Thomas

Bushcare: Steve Lukacs

Ranger: Taylor Heath

LIFE & HONORARY MEMBERS

Rodney Attwood

Victor Gostin

Don Bursill

Olga Gostin

Margaret Bursill

Mary Lane

Merv Fenwick

Roger Collier

Jill Fenwick

David Sheppard



Thanks go to our Sponsors:



Club of
Modbury Golden Grove



Olivia Savvas MP
MEMBER FOR NEWLAND

Office 4, 1257 North East Rd,
Ridgehaven SA 5097
8264 4482
newland@parliament.sa.gov.au



OliviaSavvasNewland



FRIENDS OF PARKS
SOUTH AUSTRALIA

Volunteers working for conservation



UNIT 2, 140 TOLLEY ROAD, ST AGNES 8396 3685

Contact Details

Website address: <https://friendsofparkssa.org.au/members/members-directory/friends-of-anstey-hill-recreation-park>

Facebook: <http://www.facebook.com/friendsofansteyhill>

Email: anstey.friends@gmail.com

